



59 Voltri Street CHELTENHAM VIC

4 🏠 1 🚗 2 🚗

Hidden behind the perfect family-friendly garden, this warm and inviting home is a tempting opportunity to get into an irresistible amenity-rich neighbourhood. Providing a versatile floorplan, immediate comfort and just the right amount of potential to add your own taste, the home will appeal to buyers looking to create a dream base for their family's future

Across the leafy and securely-fenced garden, the layout features a spacious lounge (wood-burner) that flows through to a sun-filled dining room and comfortable family zone. Looking out to the north-facing garden providing areas of sun & shade as well as scope for alfresco entertaining, this space connects with yet more adaptable living space fitted with ample storage.

Enjoying garden outlooks, the bright kitchen has been appointed with sleek stainless steel appliances, whilst four generous double bedrooms each with robes share a central spa bathroom and separate WC. Ducted heating/cooling is a comfortable highlight - concluding a welcoming package are a laundry with garden access, water tanks and driveway parking.

Steps to The Naked Racer, a walk to Mentone Racecourse Reserve and within minutes of bus routes and DFO, the

Price : \$ 1,160,000
Land Size : 532 sqm
View : <https://www.lewinrealestate.com.au/sale/vic/bayside/cheltenham/residential/house/6663953>



Lesley Whyley
0428277263



Brian Lewin
0434047939

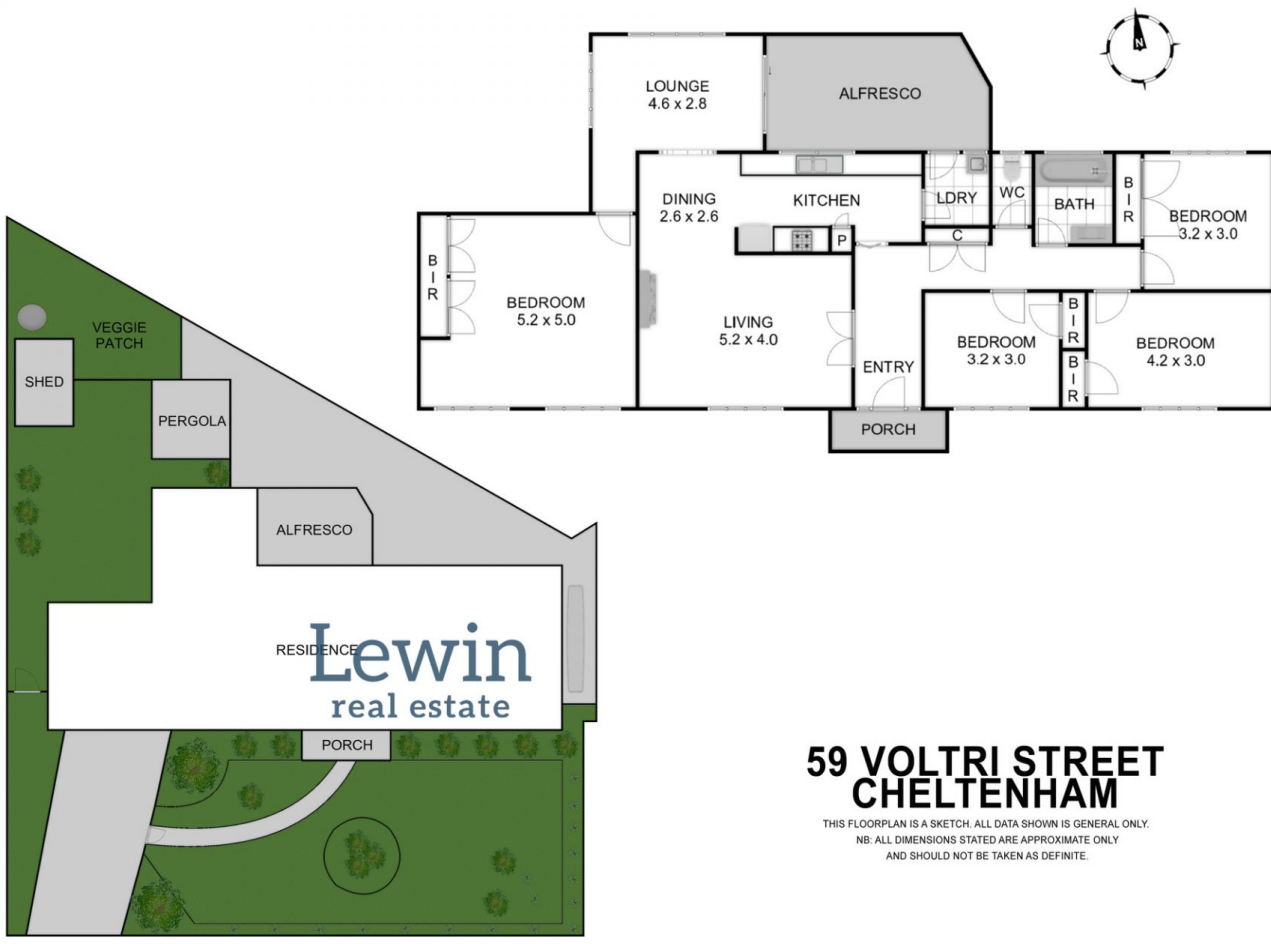

SITE PLAN

59 VOLTRI STREET CHELTENHAM

THIS FLOORPLAN IS A SKETCH. ALL DATA SHOWN IS GENERAL ONLY.
NB: ALL DIMENSIONS STATED ARE APPROXIMATE ONLY
AND SHOULD NOT BE TAKEN AS DEFINITE.