



8 Mena Avenue CHELTENHAM VIC

3 2 2

Wrapped in lush gardens that create a truly private hideaway, this beautifully presented family home occupies a prized position within the sought-after Golden Triangle. A perfect alfresco setting for summer get-togethers and a welcoming retreat for the colder months, this is a place that anyone would long to call "Home?".

Screened, secluded and secure, a private front garden with decked entrance provides the first welcome. High ceilings and warm timber flooring star throughout the spacious accommodation that enjoys views out to the flourishing greenery no matter which way you turn. Featuring a cosy open Caesarstone fireplace in the open plan living and dining zone, entertainers will appreciate how this zone extends effortlessly to the sparkling Caesarstone kitchen complete with Bosch dishwasher. Out in the tropical-inspired gardens, an alfresco deck stretches around to offer up ample space to unwind in the sun, whilst down a meandering timber pathway, a sheltered BBQ zone will set the scene for countless laidback dinners.

Generous robes and split systems are convenient inclusions in the bedrooms, the master also boasting a

Land Size : 634 sqm
View : <https://www.lewinrealestate.com.au/sale/vic/bayside/cheltenham/residential/house/6747692>



Brian Lewin
0434047939



Sharyn Weir
0413805107

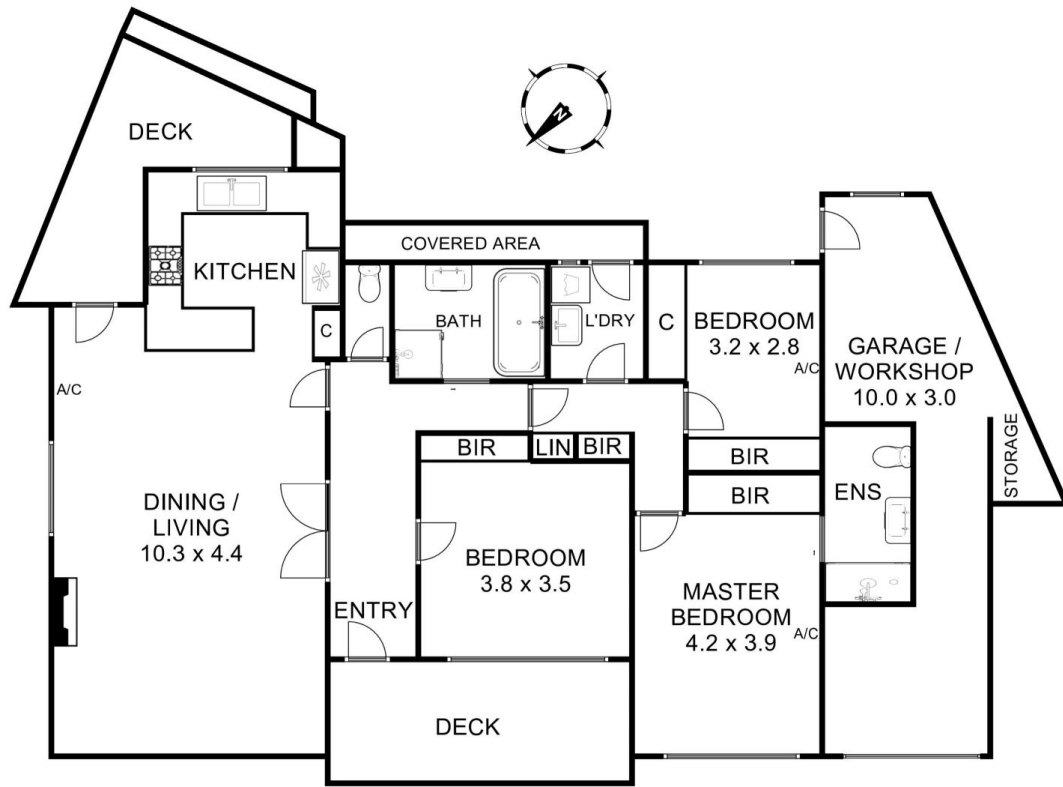

Lewin
real estate

8 Mena Avenue Cheltenham

THIS FLOOR PLAN IS A SKETCH ALL DATA SHOWN IS GENERAL ONLY.
NB. ALL DIMENSIONS STATED ARE APPROXIMATE ONLY
AND SHOULD NOT BE TAKEN AS DEFINITE