

### 327/8 Railway Road CHELTENHAM VIC

1 1 1

Rising above the very centre of Cheltenham with every daily necessity, desire and want right at the doorstep, this sleek & streamlined lifestyle abode delivers exactly that? a fabulous lifestyle. Offering the ultimate in workday convenience, it is also positioned for an easy trip down to the beach for special leisure days on the sand.

Open plan and filled with natural light, the layout comprises a well-sized living/dining zone which flows from a neat stone kitchen complete with dish-drawer dishwasher and out to a sheltered balcony enjoying views across the neighbourhood.

The peaceful bedroom is a spacious double that benefits from fitted wardrobes, whilst a sparkling fully-tiled bathroom, Euro laundry and split system heating/cooling are also offered.

With the reassurance of secure entry to the building plus an assigned basement car-space, this lowest of maintenance homes also enjoys residents' access to stylish alfresco & BBQ areas perfect for entertaining guests outdoors. Literally metres from the station, shops & cafes, this prime position is close to beautiful parklands, well-regarded golf courses and an easy trip to Southland & DFO.

**Price** : \$ 330,000

**View** : <https://www.lewinrealestate.com.au/sale/vic/bayside/cheltenham/residential/apartment/7831360>



**Lesley Kilby**  
0428277263



**Brian Lewin**  
0434047939

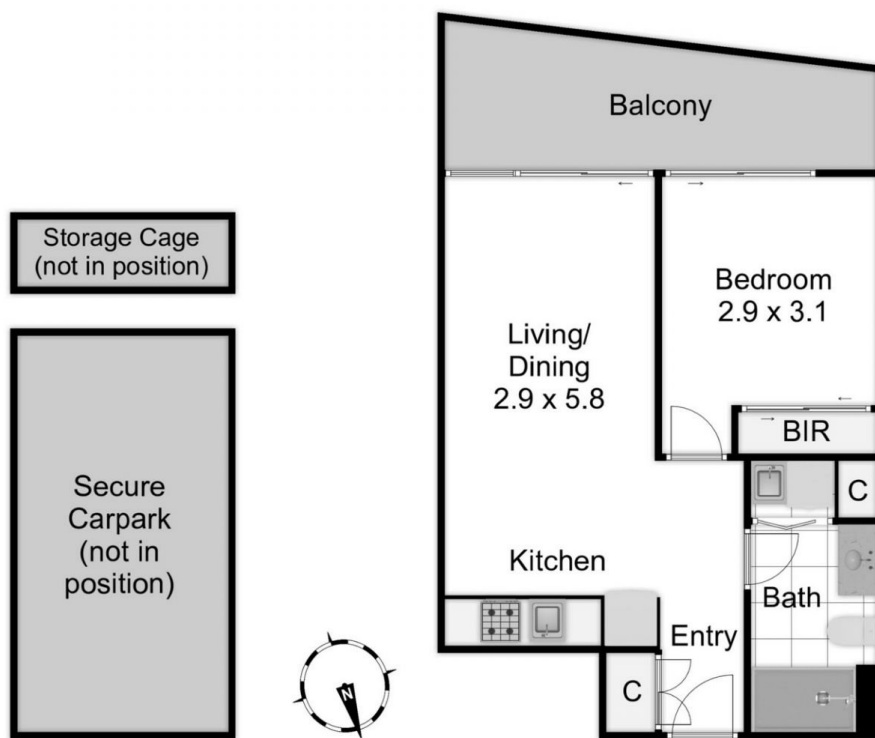

**Lewin**  
real estate

**327/8 Railway Road  
Cheltenham**

This floorplan is a sketch. All data shown is general only.  
NB: All dimensions stated are approximate only and should not be taken as definite.