



**11a Norland Street CHELTENHAM VIC**

**4** **2** **2**

Experience the thrill of just-completed luxury thanks to the high-quality style of this sensational town residence in the friendliest neighbourhood. From the upgraded façade enhanced by designer reclaimed-style brickwork right to the dappled light of the rear alfresco deck - and everything in between - this is a setting you will immediately want to call home.

Wrapped in low maintenance landscaped gardens, the accommodation features a very liveable layout, welcomed by a practical study nook then flowing through to the fabulous entertaining zone featuring a gourmet Caesarstone kitchen with premium Ilve appliances, a walk-in pantry and long island bench. The spacious living and dining area is ideal to first welcome guests before heading out to the deck overlooking a lawned garden - oriented to the west for afternoon warmth, it is also shaded by trees for perfect privacy and comfort.

Families will find the space they need upstairs with three primary bedrooms including a gorgeous master with walk-in robe and luxe ensuite complete with twin vanity and black tapware. A versatile fourth bedroom or second living area can adapt to your needs, whilst the chic main bathroom boasts a freestanding bath, striking tiles and convenient

**Price** : \$ 1,420,000

**View** : <https://www.lewinrealestate.com.au/sale/vic/bayside/cheltenham/residential/house/7877522>



**Brian Lewin**  
**0434047939**



**John Hassett**  
**0437452514**

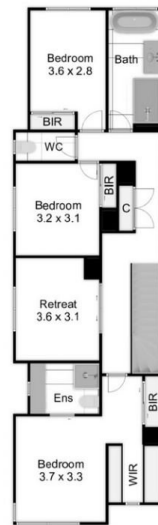

11a Norland Street  
Cheltenham

This floorplan is a sketch. All data shown is general only.  
NB: All dimensions stated are approximate only  
and should not be taken as definite.