

21 Stonehaven Crescent, Hampton East



21 Stonehaven Crescent HAMPTON EAST VIC

3 1 2

In an evolving neighbourhood, with an ever-changing streetscape that includes both classic-style homes as well as luxurious new showstoppers, this prime 762sqm allotment (approx.) is your chance to create something truly special.

Beachside of the highway in a quiet low-traffic pocket of Hampton East, this much-loved blonde brick home has been cherished by its current owner for close to X decades. With three bedrooms, a lounge and well-equipped kitchen with stainless steel appliances plus a meals area and original 'retro' bathroom, the existing accommodation is ready to move into or rent out, while providing plenty of exciting scope for an easy modern makeover.

But with such generous dimensions and a location to envy, the property will no doubt entice developers and families seeking the perfect site for a spectacular brand-new masterpiece. Take inspiration from nearby homes/townhouses or engage an architect to conjure up something undeniably unique - all options STCA.

A stroll to Moorabbin's retail precinct and enjoying easy access to Moorabbin Station, bus stops and the Nepean Highway for a stress-free commute, this tightly-held Bayside pocket is within moments of highly-regarded public

Price : \$ 1,575,000
Land Size : 769 sqm
View : <https://www.lewinrealestate.com.au/sale/vic/bayside/hampton-east/residential/house/7958432>



Brian Lewin
0434047939



Lesley Kilby
0428277263

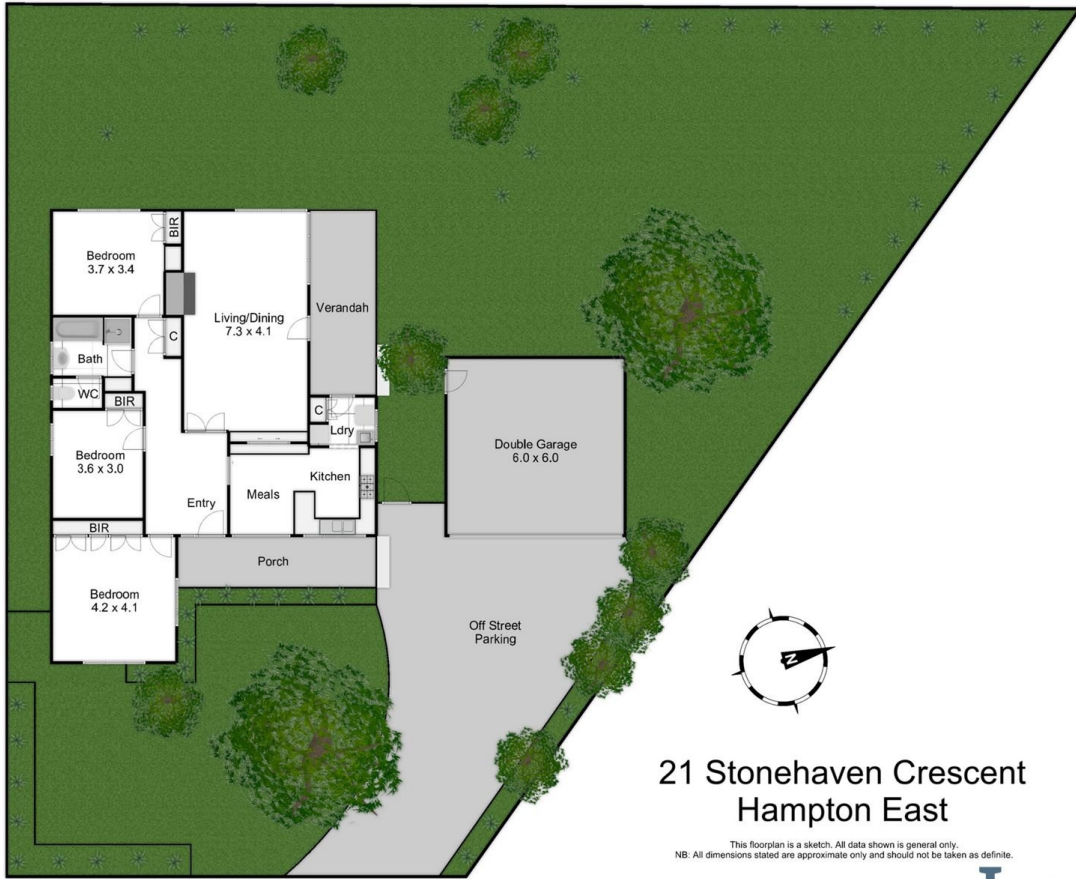

21 Stonehaven Crescent
Hampton East

This floorplan is a sketch. All data shown is general only.
NB: All dimensions stated are approximate only and should not be taken as definite.

Lewin
real estate