



### 3/19 Tulip Grove CHELTENHAM VIC

2 1 1

Nestled discreetly at the back of a tranquil block, this remarkable unit has undergone a complete makeover to fashion a luminous haven that will captivate you. Situated conveniently on the seaside of the highway, near parks and transportation, and just a brief walk from Southland, with two golf courses nearly within reach. Featuring two spacious double bedrooms, each boasting built-in wardrobes, along with a generous living room. The bright kitchen and dining area will enchant you with its expansive Caesarstone countertop, stainless-steel European appliances, ample storage, and premium finishes. The newly renovated bathroom showcases a chic vanity and a sizable walk-in shower. Outside, the splendid rear courtyard beckons for al fresco dining or unwinding at day's end. It flaunts a split-level paved and decked entertainment space, complete with a built-in barbecue, ambient deck lighting, and bench seating. Additionally, there's a separate toilet, linen closet, sizable laundry, and a secure garage with off-street parking. Boasting extras like ducted heating, air-conditioning, Day/Night blinds, and polished floorboards, this exceptional brick-veneer unit offers an ideal, low-maintenance lifestyle. For a viewing, please contact Lisa Devola on 0438 766 821.

**Price** : \$599

**View** : <https://www.lewinrealestate.com.au/lease/vic/bayside/cheltenham/residential/unit/7966278>

## Unit 3, 19 Tulip Gr, Cheltenham

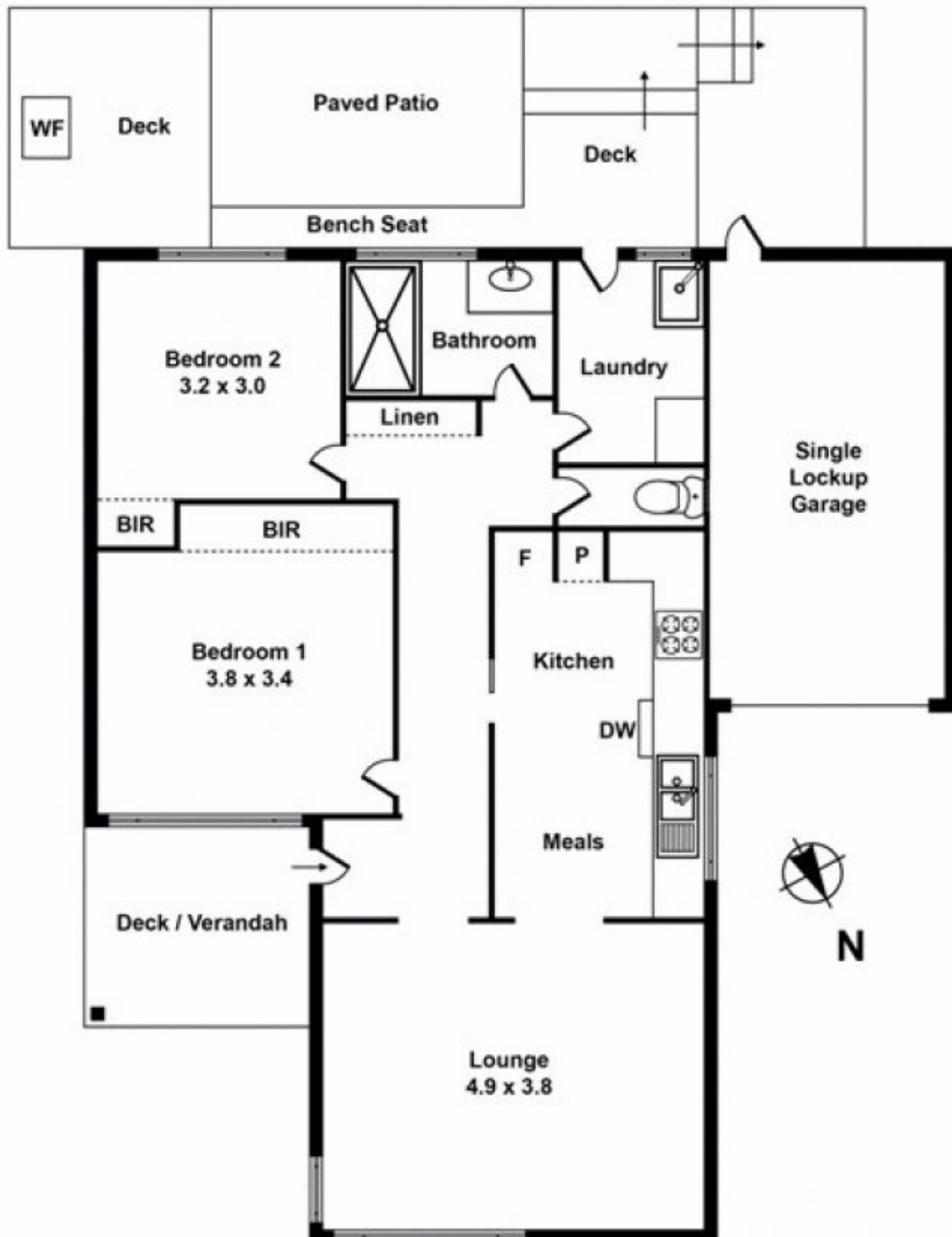

Whilst every attempt has been made to ensure the accuracy of this floorplan, measurements of doors, windows, rooms and any other items are approximates only. The producer or agent cannot be held responsible for any errors, omissions or misstatements. This plan is for illustrative purposes only and should be used as such.