



5103/185 Weston Street BRUNSWICK EAST VIC

1 1 1

With outdoor areas front and back ensuring a flow of fresh air, this stylish Lock & Leave apartment delivers a coveted low maintenance lifestyle perfect for any busy buyer.

Situated in a sleek Rothelowman Architect designed development that rises above the former Tip Top factory, the home flaunts luxe light-filled interiors which comprise an open plan living and dining area spilling to a generous north-facing terrace. Connecting in with a modern kitchen appointed with premium Smeg appliances, this space then flows on to a fabulous designated study zone which will prove popular for anyone working or studying from home. Further on, the spacious double bedroom boasts a stretch of fitted wardrobing and extends out to a private alfresco area creating an ideal space to relax over coffee or drinks and enjoy the vibrant outlooks.

A sparkling bathroom concealing practical Euro laundry facilities is also on offer together with the comfort of split system heating/cooling, while a coveted basement parking space and storage cage plus video intercom to the building

[For full version visit the website](https://www.lewinrealestate.com.au/sale/vic/north/brunswick-east/residential/apartment/7972674)

Type : Apartment
Price : \$ 392,000
View : <https://www.lewinrealestate.com.au/sale/vic/north/brunswick-east/residential/apartment/7972674>



John Hassett
0437452514



Brian Lewin
0434047939

Lewin
real estate

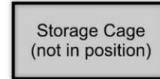
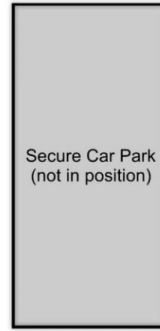
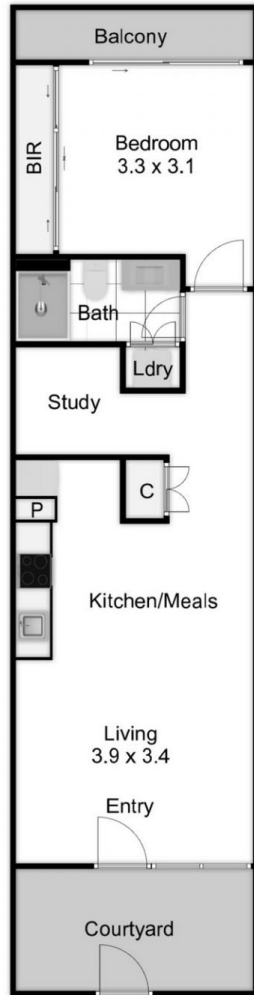

5103/185 Weston Street
Brunswick East

This floorplan is a sketch. All data shown is general only.
NB: All dimensions stated are approximate only
and should not be taken as definite.