





2/36 Hyssop Drive HALLAM VIC

3  **2**  **2** 

Nestled in a tranquil pocket, this near-new modern home offers premium features and a thoughtful design throughout.

Be greeted by a light-filled open-plan living and dining area that seamlessly connects to a well-appointed kitchen. The kitchen boasts quality stainless-steel appliances, including a dishwasher, stone benchtops, ample storage, a stylish feature tile splashback, and serene views across horse paddocks. Completing the ground floor is a spacious laundry with external access and a convenient powder room.

Upstairs, the master bedroom features a walk-in wardrobe and a bright, spacious ensuite with plenty of storage. The second bedroom includes a mirrored built-in wardrobe and is serviced by the adjacent main bathroom with generous storage options. A third bedroom or study is located downstairs, while upstairs also offers a cozy retreat space, ideal for a home office with a view.

[For full version visit the website](#)

Type : Townhouse

View : <https://www.lewinrealestate.com.au/lease/vic/sou-th-east/hallam/residential/townhouse/8227277>

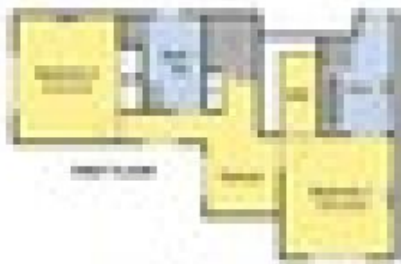

3700 Highway 10, Victoria, BC, V8N 4M6
 www.victoria.ca

